

If you need date inserts,  
Please contact us.  
sales@viewmold.com

# D-M-E Mold Dating Inserts

Industry-leading  
mold dating inserts  
available in two styles



# D-M-E Standard Mold Dating Inserts

If you need date inserts,  
Please contact us.  
sales@viewmold.com



## **Indexable** Mold Dating Inserts provide:

- Indexable snap-in-place alignment of arrow
- Unique design keeps inner insert flush for three full turns

## **Indexable and Front Removable Inserts provide:**

- Provides product traceability required in part quality programs
- Molds year, month, day, shift or numerals (0-9) on part for batch identification or product quality control
- Inner insert is easily adjustable and removable using a screwdriver
- Date-sensitive inner inserts can be changed at the parting line without removing outer insert from the mold
- Broad variety of insert dating combinations available
- 6mm, 8mm, 10mm, 12mm, 16mm and 20mm diameters available
- Available in two styles: Indexable and Front Removable

### Indexable Inserts



AVAILABLE IN 6 SIZES

### Front Removable Inserts



AVAILABLE IN 6 SIZES

### D-M-E Family of Mold Dating Inserts



If you need date inserts,  
Please contact us.  
sales@viewmold.com

### Features of Indexable and Front Removable Inserts

- Designed for plastic injection molds
- Maximum operating temperature is 300°F
- Press-fit installation required
- Numerals are 0.2mm deep and arrow is 0.4mm deep
- Arrow is adjustment slot

### Dimensions and Tolerances of Indexable and Front Removable Inserts

**Material:** Stainless Steel  
**Hardness:** 50-55 HRc

D DIA	TOLERANCE		L	INDEXABLE F DIA	FRONT REMOVABLE F DIA
	m6	h7			
6	+0.012 to +0.004	0 to -0.012	8	3.7	3.1
8	+0.015 to +0.006	0 to -0.015	10	5.0	4.4
10	+0.015 to +0.006	0 to -0.015	12	6.3	5.2
12	+0.018 to +0.007	0 to -0.018	14	7.5	6.2
16	+0.018 to +0.007	0 to -0.018	14	11.0	8.2
20	+0.021 to +0.008	0 to -0.021	16	13.2	11

### Indexable

U.S. Patent No. 5,788,872

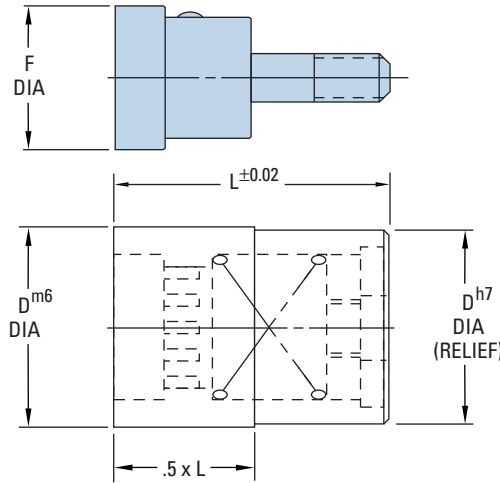
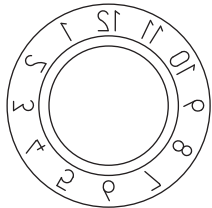
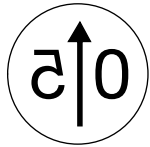

### Front Removable

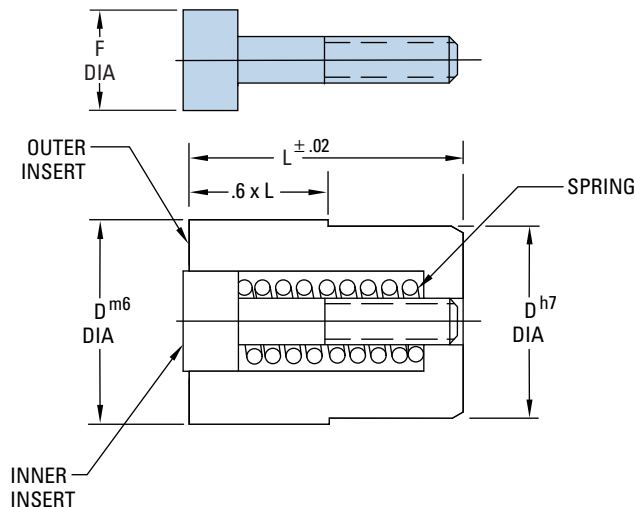

### Front Removable Springs









ITEM NUMBER (package of 5)	D DIA
DFQ9006	6
DFQ9008	8
DFQ9010	10
DFQ9012	12
DFQ9016	16
DFQ9020	20

### NOTE:

Springs are for Front Removable only. Indexable springs are built in.

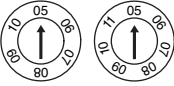
All dimensions and tolerances are in mm.

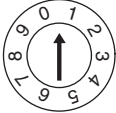
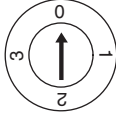
**Complete Assemblies**

DESCRIPTION	D DIA (MM)	INDEXABLE ITEM NUMBER	FRONT REMOVABLE ITEM NUMBER
 Month (Outer), Year & Arrow (Inner)	6	UYM_*_06	FYM_*_06
	8	UYM_*_08	FYM_*_08
	10	UYM_*_10	FYM_*_10
	12	UYM_*_12	FYM_*_12
	16	UYM_*_16	FYM_*_16
 Month (Outer), Arrow (Inner)	6	UOM0006	FOM0006
	8	UOM0008	FOM0008
	10	UOM0010	FOM0010
	12	UOM0012	FOM0012
	16	UOM0016	FOM0016
 (6) (7) Years (Outer) Arrows (Inner)	6	UOY_*_06	FOY_*_06
	8	UOY_*_08	FOY_*_08
	10	UOY_*_10	FOY_*_10
	12	UOY_*_12	FOY_*_12
	16	UOY_*_16	FOY_*_16
 Day (Outer), Arrow (Inner)	12	—	FOD0012
	16	UOD0016	FOD0016
	20	UOD0020	FOD0020
 "Numerals" (0 thru 9)	6	UOR0006	FOR0006
	8	UOR0008	FOR0008
	10	UOR0010	FOR0010
	12	UOR0012	FOR0012
	16	UOR0016	FOR0016
 "Shift" (Outer), Arrow (Inner)	6	UOS0006	FOS0006
	8	UOS0008	FOS0008
	10	UOS0010	FOS0010
	12	UOS0012	FOS0012
	16	UOS0016	FOS0016
 Blank (Outer), Arrow (Inner)	6	UOB0006	FOB0006
	8	UOB0008	FOB0008
	10	UOB0010	FOB0010
	12	UOB0012	FOB0012
	16	UOB0016	FOB0016
20	UOB0020	FOB0020	



**NOTES:**

- When ordering date-sensitive assemblies, add digits of engraved year required where asterisks (\*) are shown in item number (e.g., UUY0516).
- Availability of year-sensitive items will vary during last quarter of each calendar year. Order next-year's Mold Dating Inserts during October to beat the rush.

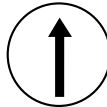
**Inner Inserts**

DESCRIPTION	D DIA (MM)	INDEXABLE ITEM NUMBER	FRONT REMOVABLE ITEM NUMBER
 Year & Arrow	6	YUU_*_06	YON_*_06
	8	YUU_*_08	YON_*_08
	10	YUU_*_10	YON_*_10
	12	YUU_*_12	YON_*_12
	16	YUU_*_16	YON_*_16
 Arrow	6	OOU0006	OON0006
	8	OOU0008	OON0008
	10	OOU0010	OON0010
	12	OOU0012	OON0012
	16	OOU0016	OON0016
20	OOU0020	OON0020	

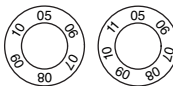
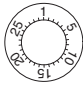
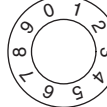
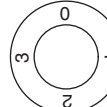
**Outer Rings**

DESCRIPTION	D DIA (MM)	INDEXABLE ITEM NUMBER	FRONT REMOVABLE ITEM NUMBER
 Month (1 thru 12)	6	UUM0006	OOM0006
	8	UUM0008	OOM0008
	10	UUM0010	OOM0010
	12	UUM0012	OOM0012
	16	UUM0016	OOM0016
 (6) (7) Years	6	UUY_*_06	OY_*_06
	8	UUY_*_08	OY_*_08
	10	UUY_*_10	OY_*_10
	12	UUY_*_12	OY_*_12
	16	UUY_*_16	OY_*_16
 Day (1 thru 31)	12	—	OOD0012
	16	UUD0016	OOD0016
	20	UUD0020	OOD0020
 "Numerals" (0 thru 9)	6	UUR0006	OOR0006
	8	UUR0008	OOR0008
	10	UUR0010	OOR0010
	12	UUR0012	OOR0012
	16	UUR0016	OOR0016
 "Shift" (0 thru 3)	6	UUS0006	OOS0006
	8	UUS0008	OOS0008
	10	UUS0010	OOS0010
	12	UUS0012	OOS0012
	16	UUS0016	OOS0016
20	UUS0020	OOS0020	
 Blank	6	UUB0006	OOB0006
	8	UUB0008	OOB0008
	10	UUB0010	OOB0010
	12	UUB0012	OOB0012
	16	UUB0016	OOB0016
20	UUB0020	OOB0020	